



UL LLC
1075 W Lambert Rd Suite B
Brea, CA 92821

Photometric Test Report

Relevant Standards
IES LM-79-2008, ANSI C82.77-2002, CIE 13.3-1995
CIE 15-2004, ANSI C78.377-2017, IES TM-30-2018

Prepared For
Express Imaging Systems LLC dba Evluma

Blake Coudriet
3600 Lind Ave SW Suite 140
Renton, WA 98057
United States

Catalog Number
AX-70-40-5-D

Order Number
12698741
Test Number
12698741.01

Test Date

2019-02-20 - 2019-02-22

Prepared By

Khang Nguyen, Technician

Approved By

Eric Gaudreau, Engineering Leader

The results contained in this report pertain only to the tested sample.
This report shall not be reproduced, except in full, without written approval of Underwriters Laboratories.
This report must not be used by the client to claim product certification, approval, or endorsement by
NVLAP, NIST, or any agency of the Federal Government.



Table of Contents

Summary of Results	Page 3
Integrating Sphere Results	Page 4
Distribution Results	
Test Conditions / Summary of Results / ISOPlot	Page 5
Maximum Plane and Cone Plot / Zonal Lumen Summary	Page 6
IES BUG Rating	Page 7

Laboratory results may not be representative of field performance
Ballast factors have not been applied

Testing was performed in a 3-meter integrating sphere using the 4π geometry method.

Absorption correction was employed for Sphere measurement

Tested in 30 planes left side, 30 planes right side, left and right averaged

Vertical test increments are 2.5 degrees

Test distance exceeds five times the greatest luminous opening of luminaire



Luminaire Description: Gray metal housing, white plastic reflector and prismatic dome glass lens
Lamp: One (1) white LED with optic below
Mounting: Pole/Arm

Luminaire

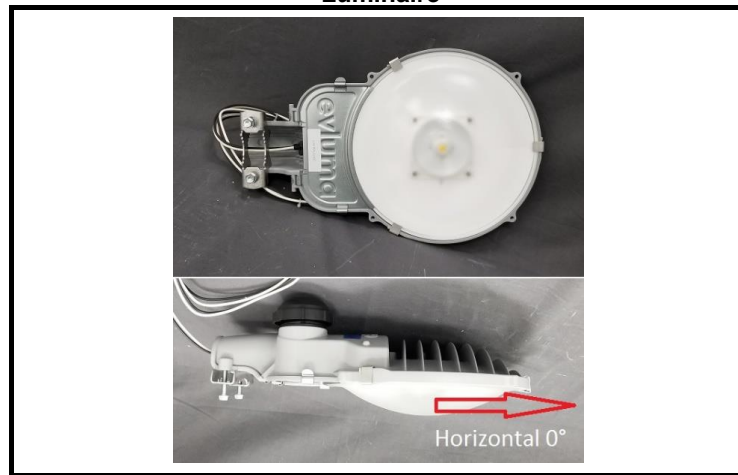

Luminaire Characteristics

Luminous Diameter: 11.00 in.
Luminous Height: 1.50 in.

Summary of Results

Integrating Sphere

Luminous Flux: 10410 Lumens
Efficacy: 147.75 lm/w
CCT: 3987 K
CRI (Ra): 70.5

Distribution

Roadway Classification: Type V, Short
Cutoff Classification: Cutoff
BUG Rating: B3 U2 G2

Electrical Data at 120 VAC

Test Temperature: 25.5 °C
Voltage: 120.1 VAC
Current: 0.5884 A
Power: 70.46 W
Power Factor: 0.998
Frequency: 60 Hz
Current THD: 6.83 %



Color Quality - Integrating Sphere

Integrating Sphere Test Conditions

Temperature	Voltage	Current	Power	Power Factor	Frequency	Current THD
25.5 °C	120.1 VAC	0.5884 A	70.46 W	0.998	60 Hz	6.83 %

Summary of Results

Total Output:	10410 Lumens	Chromaticity (x):	0.3830
Efficacy:	147.8 lm/w	Chromaticity (y):	0.3850
CCT:	3987 K	Chromaticity (u'):	0.2236
CRI (Ra):	70.5	Chromaticity (v'):	0.5055
CRI (R9):	-29.1	TM-30 Rf:	73.1
Peak Wavelength:	451 nm	TM-30 Rg:	93.2
Dominant Wavelength:	578 nm	Duv:	0.0030
S/P Ratio:	1.48		

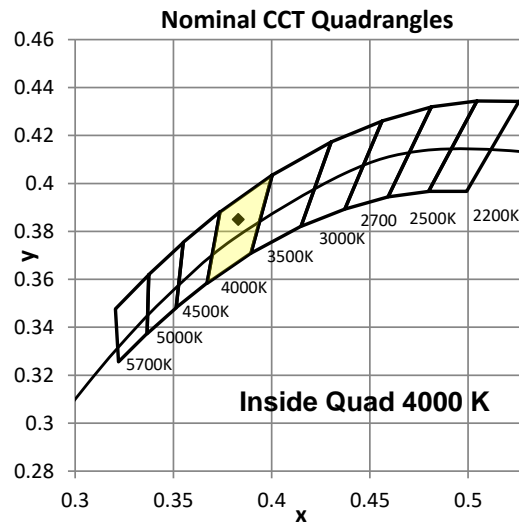
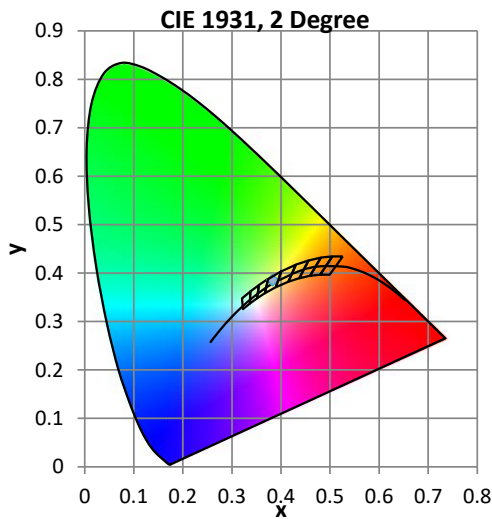

Color Rendering Index Detail

Ra (CRI)	R1	R2	R3	R4	R5	R6	R7	R8	R9	R10	R11	R12	R13	R14	R15
70.5	67.5	76.9	83.2	69.2	66.2	66.2	81.8	53.2	-29.1	43.9	62.5	34.9	68.8	90.1	61.4

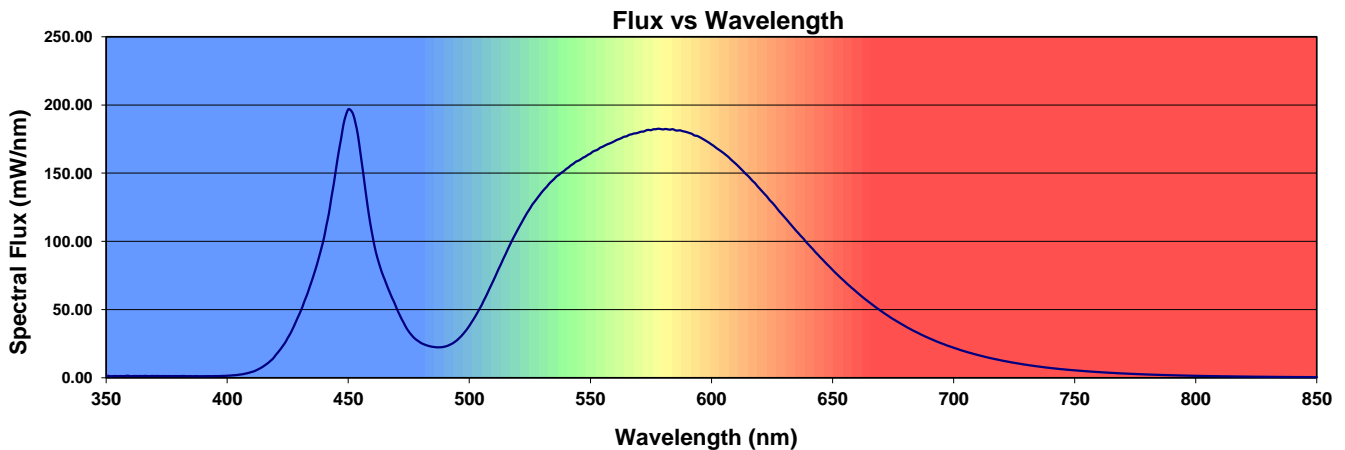



Distribution - Goniophotometer

Distribution Test Conditions

Temperature	Voltage	Current	Power	Power Factor	Frequency	Current THD
25.0 °C	120.0 VAC	0.5894 A	70.54 W	0.998	60 Hz	6.75 %

Summary of Results

IES Roadway Classification:	Type V, Short	Total Lumen Output:	10024 Lumens
Cutoff Classification	Cutoff	Luminaire Efficacy:	142.1 lm/w
BUG Rating:	B3 U2 G2	Maximum Candela:	3458 Candela

ISO FootCandle Plot at 20 Feet

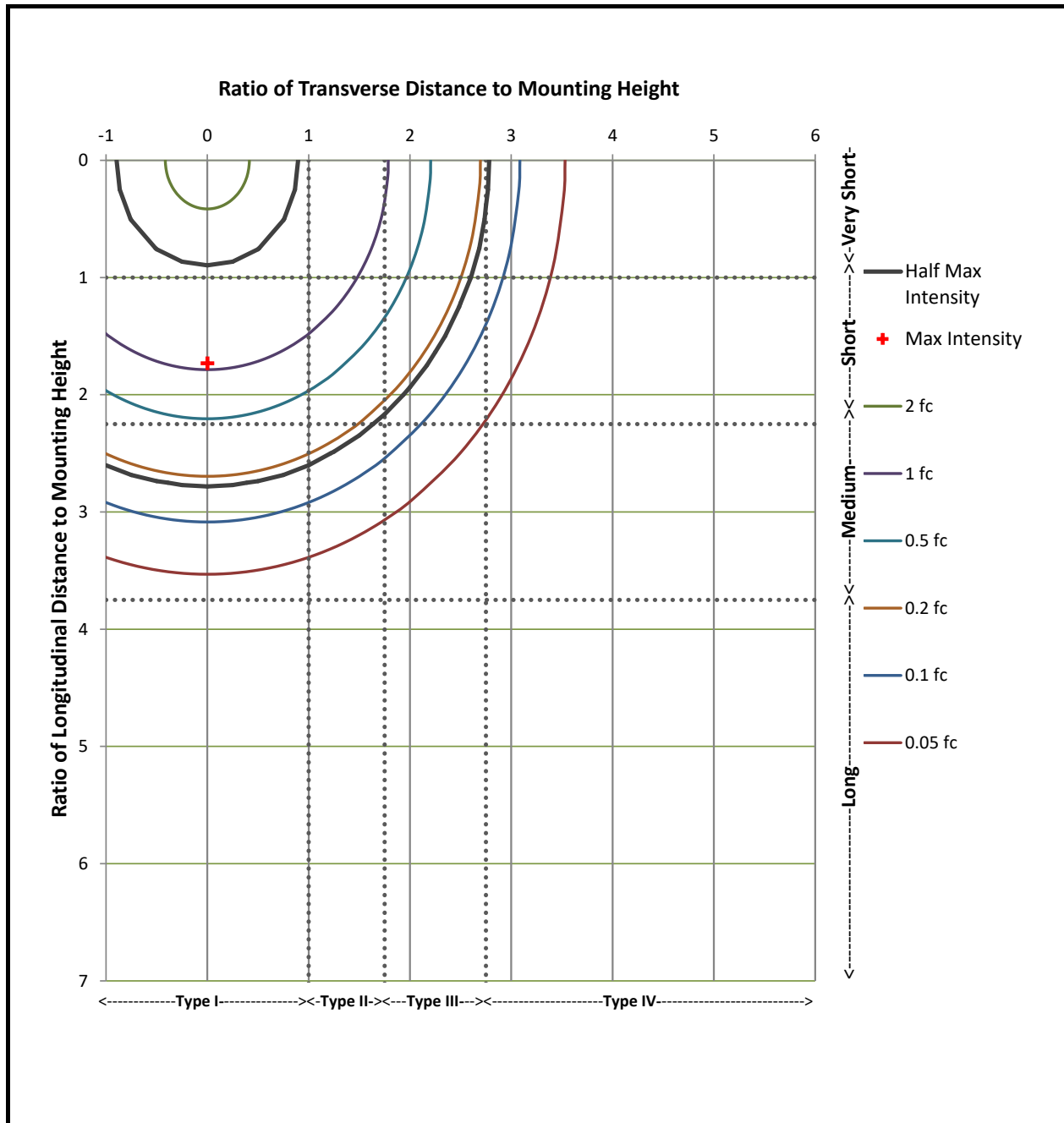



Maximum Plane and Cone Plots of Candela

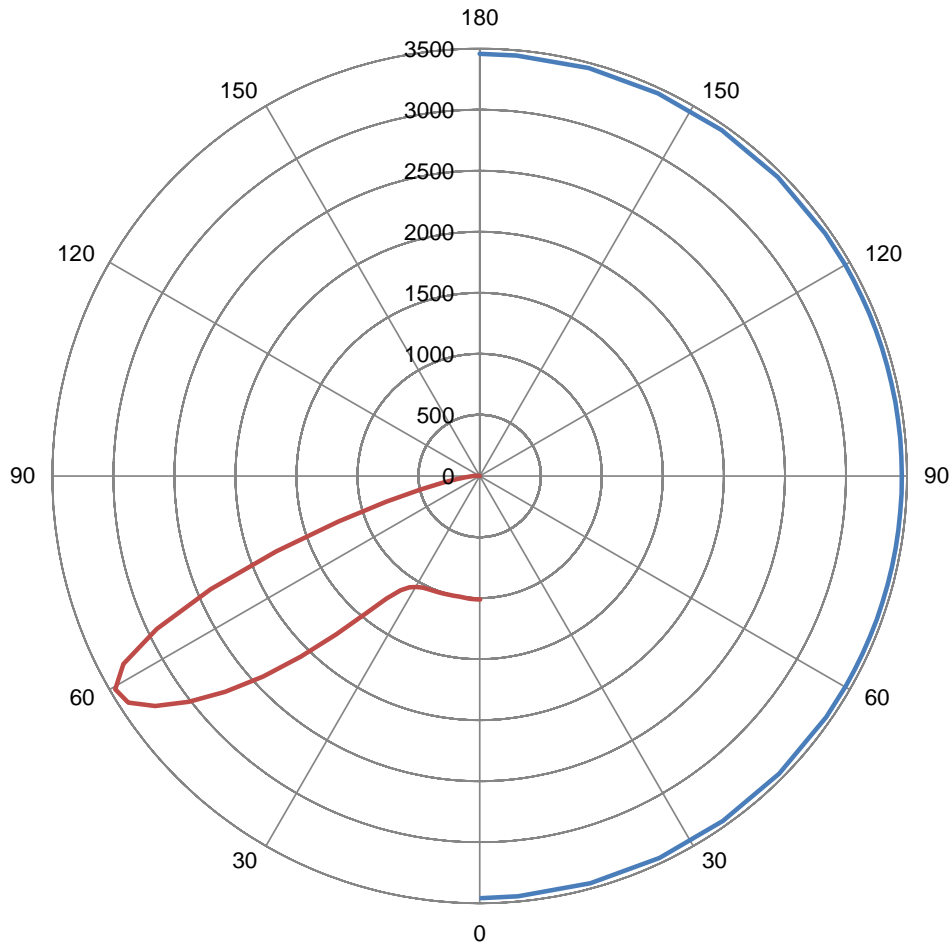

Vertical Plane Through

0 ° Lateral

Lateral Cone Through

60 ° Vertical

Maximum Intensity (Candlepower):

3458 Candela

Zonal Lumen Summary

Zone	Lumens	% of Luminaire	Zone	Lumens	% of Luminaire	Zone	Lumens	% of Luminaire
0-5	25.7	0.3%	60-65	1576.5	15.7%	120-125	0.8	0.0%
5-10	71.9	0.7%	65-70	1198.0	12.0%	125-130	0.6	0.0%
10-15	119.0	1.2%	70-75	651.1	6.5%	130-135	0.4	0.0%
15-20	166.1	1.7%	75-80	281.1	2.8%	135-140	0.2	0.0%
20-25	212.9	2.1%	80-85	112.1	1.1%	140-145	0.1	0.0%
25-30	261.0	2.6%	85-90	46.8	0.5%	145-150	0.0	0.0%
30-35	320.1	3.2%	90-95	21.9	0.2%	150-155	0.0	0.0%
35-40	429.1	4.3%	95-100	10.5	0.1%	155-160	0.0	0.0%
40-45	656.0	6.5%	100-105	4.6	0.0%	160-165	0.0	0.0%
45-50	977.2	9.7%	105-110	1.5	0.0%	165-170	0.0	0.0%
50-55	1308.7	13.1%	110-115	0.9	0.0%	170-175	0.0	0.0%
55-60	1568.5	15.6%	115-120	0.9	0.0%	175-180	0.0	0.0%



IES "BUG" Rating
 (Back Light, Uplight, Glare)
 Per IES TM-15-11

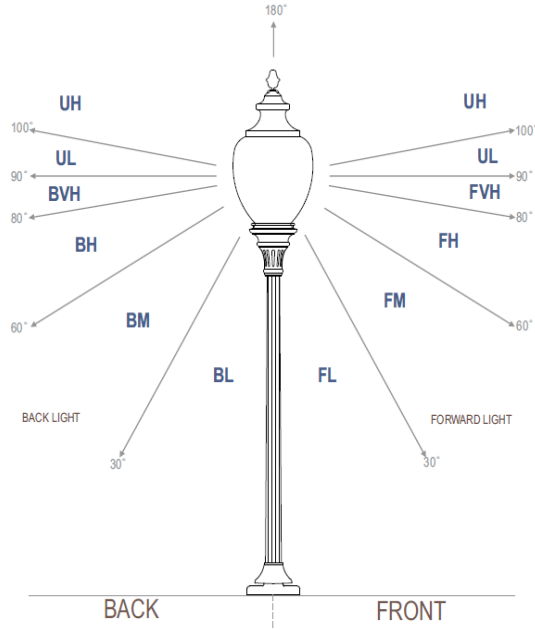

Luminaire Classification System (LCS)

LCS	Zone	Lumens	Luminaire %
FL	(0-30)	428.3	4.3%
FM	(30-60)	2629.8	26.2%
FH	(60-80)	1853.3	18.5%
FVH	(80-90)	79.4	0.8%
BL	(0-30)	428.3	4.3%
BM	(30-60)	2629.8	26.2%
BH	(60-80)	1853.3	18.5%
BVH	(80-90)	79.4	0.8%
UL	(90-100)	32.4	0.3%
UH	(100-180)	10.0	0.1%
Total		10024.0	100.0%
BUG Rating		B3 U2 G2	