

Install the Adjustable Mogul Bracket PN 35255357 with Wago Connectors

The Adjustable Mogul Bracket, see Figure 1, is intended for applications where the refractor of a dusk-till-dawn fixture is required to light up when used with the Clearlight luminaire. Remove the fixture from the electrical source prior to installing the bracket and detach the refractor. Installation instructions are based on an American Electric 100W HPS. Bracket works with both the Clearlight Beacon and the EcoSpot.

CAUTION: Modifications to an electrical fixture should be restricted to authorized personnel, or a licensed electrician.

How to Install the Adjustable Mogul Bracket

1. Loosen the two screws that secure the socket, ballast and starter within the housing, one screw on each side. See Figure 2. Remove the starter for easy access to the housing screw on the same side. Remove the screws and set aside to reuse.
2. Disconnect the black (line), white (neutral) and red photocell wire from the socket and ballast assembly. See Figure 3.

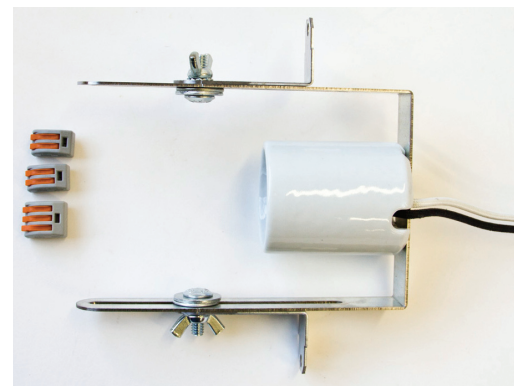

Figure 1. Adjustable Mogul Bracket.
PN 35255357.

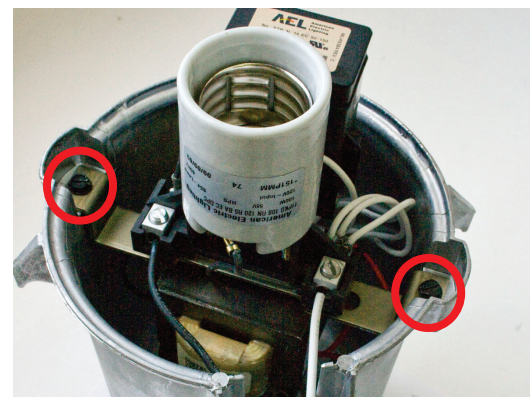

Figure 2. Remove the two screws that secure the socket, ballast and starter to the housing.

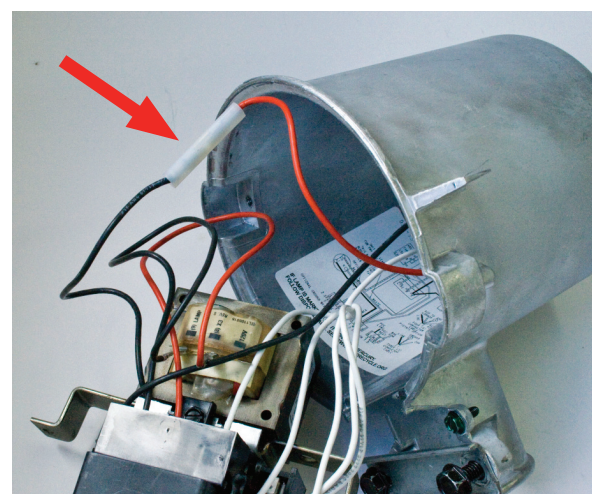
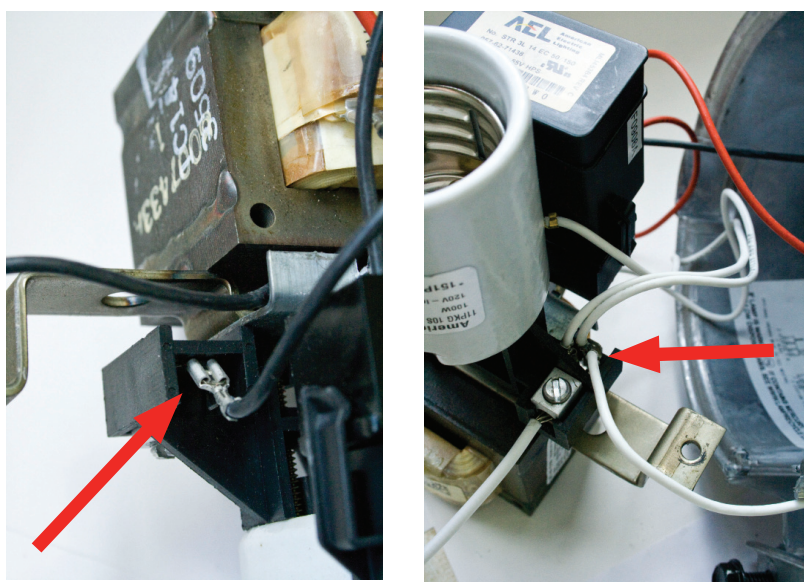

Figure 3. Disconnect the black (line), white (neutral) and red photocell wire from the socket.

3. Remove the socket, ballast and starter from inside the housing and set aside to recycle. See Figure 4. The interior of the fixture should be empty except for the photocell.

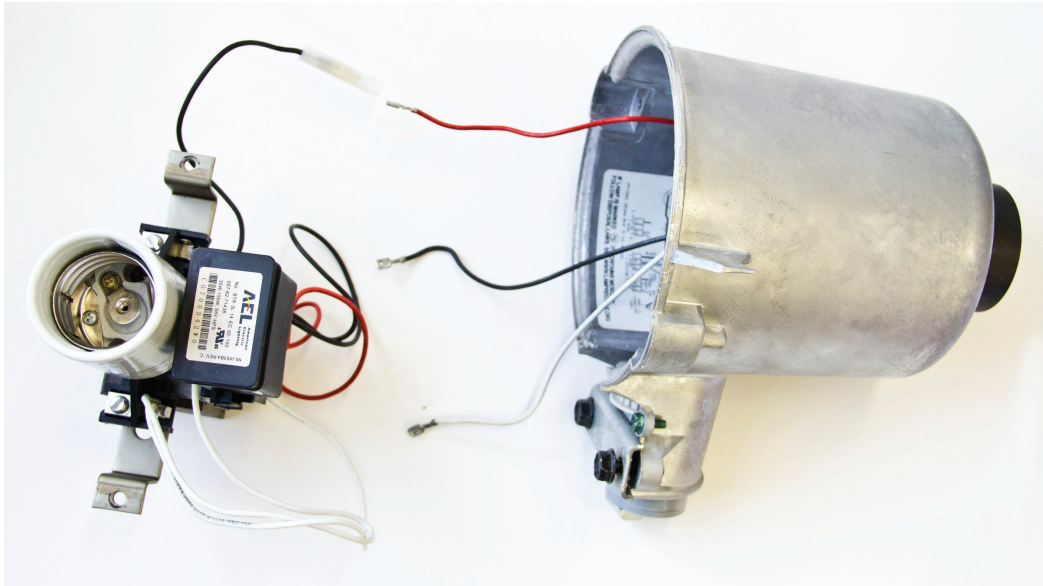

Figure 4. Remove the socket, ballast and starter from the housing.

4. Cut the connectors off the ends of the wires and strip if necessary. The Wago connectors can accept 12-28 gauge wire.

5. Insert all three neutral wires into the three conductor Wago connector: A. and A. in Figure 5 plus the incoming neutral line from the pole. Lift the orange lever to open the cage clamp and insert the conductor. The lever clicks as it is lowered, actuating the cage clamp.

6. Insert the red photocell wire and black wire from the socket into a two conductor Wago connector. B. and B. in Figure 5.

7. Insert the black wire from the fixture and the incoming black wire from the pole into a two conductor Wago connector. C. and C. in Figure 5.

8. Secure the new socket and bracket assembly to the housing.

9. Reattach the reflector and screw in the Clearlight.

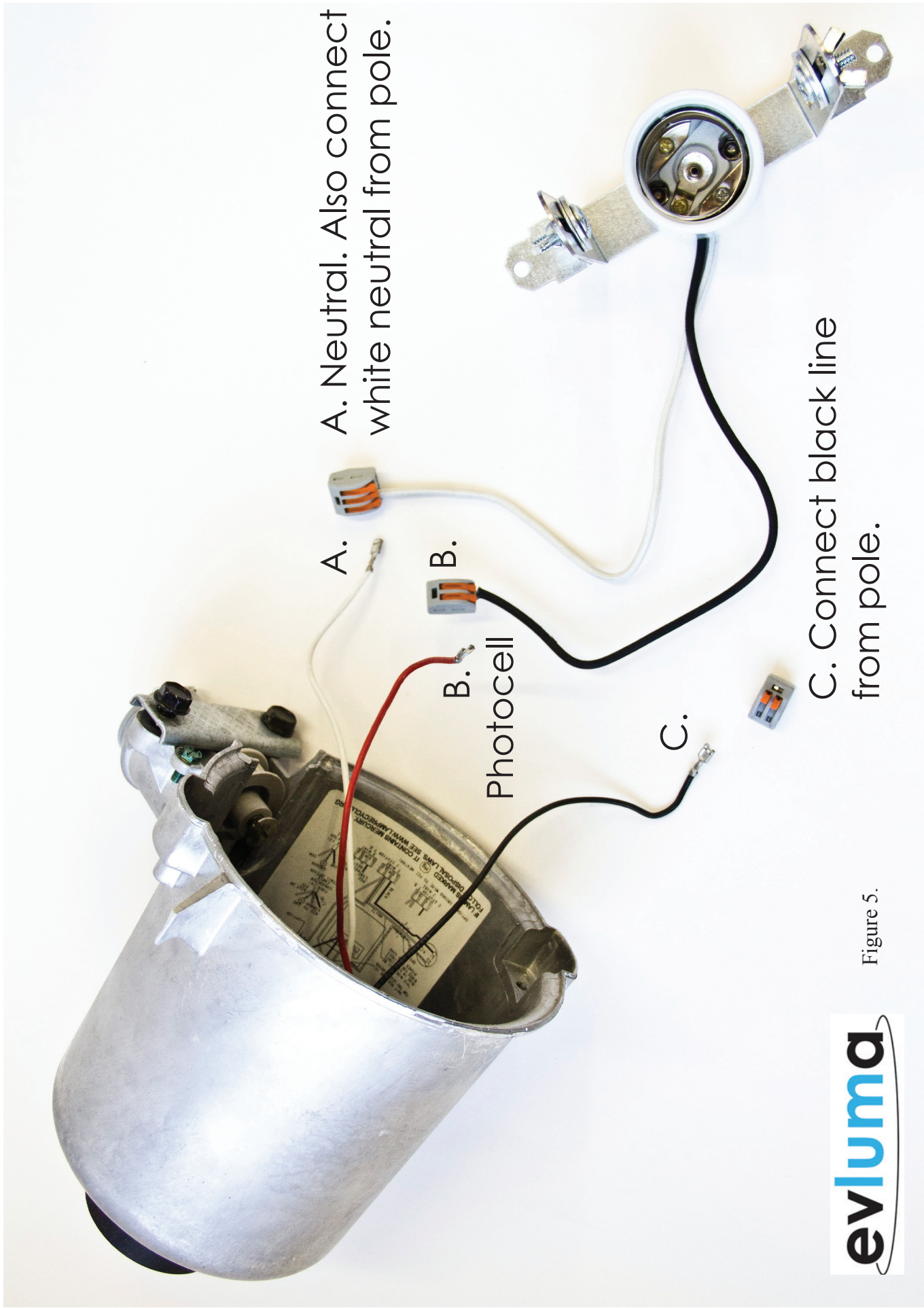

Figure 5.